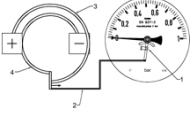
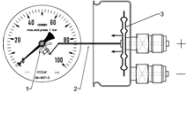
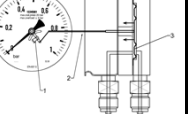
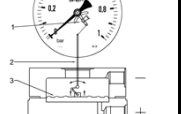
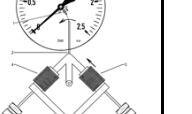
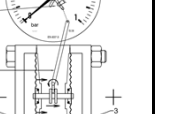

DIFFERENTIAL PRESSURE GAUGES

Selection guide

parameter		differential pressure gauge type					
		PBD	PCD	PDD	PMD	PSD	POD
operating principle		2x bourdon tube	capsule	1x diaphragm	1x diaphragm	2x bellows	2x diaphragm
range (span)	min.	0.6 bar	25 mbar case 100 6 mbar case 160	0.6 bar	250 mbar 25 mbar for type low	100 mbar	1 bar 100 mbar for type low
	max.	16 bar	400 mbar	16 bar	25 bar	6 bar	25 bar
static pressure	max.	2.5 ... 4 x range	1.5 bar case 100mm 1 bar case 160mm	20 bar	100 bar 25 bar for type low	10 x range	100 bar optional 250 bar
overload safe	max.	no	no optional max. 2 bar	4 x range 2.4 ...20 bar	no	upto static press. upto static press.	100 bar optional 250 bar
case diameter	mm	100; 160	100; 160	100; 160	100; 160		100; 160
contact device		yes	no	no	yes	no	yes
	min.	1.6 bar			1,6 bar 100 mbar for type low		1.6 bar
chemical seals <small>see catalogue page 37</small>		yes, wide range	no	yes	yes	no	yes
wetted parts		AISI316L/1.4435 AISI316Ti/1.4571 fully welded system	for clean air and dry gasses only stainless steel nickel coated brass; macrolon	AISI316L/1.4435 diaphragm duratherm Viton; PTFE	AISI316L/1.4435 diaphragm duratherm Viton; PTFE	AISI316L/1.4435 fully welded system	DP cell; AISI316L/1.4435 diaphragm duratherm Viton; PTFE
catalogue page		45	46				
operating principle <small>see also catalogue</small>							
T ambient		-20/+60 °C	-20/+50 °C	-20/+60 °C	-20/+60 °C	-20/+60 °C	-20/+60 °C
T process max.		-20/+100 °C	-20/+50 °C	-20/+80 °C	-20/+80 °C	-20/+80 °C	-20/+80 °C

DIFFERENTIAL PRESSURE GAUGE TYPE PMD

TYPE PMD, diaphragm system with two measuring chambers

STANDARD MODEL

Features : single diaphragm system
 high static pressure
 corrosion resistance
 two measuring chambers
 pressure safe upto the measuring range

Wetted parts : diaphragm duratherm
 AISI316L/1.4404; Viton

Applications : flow measurement
 petrol chemical industry
 filter applications
 general industry
 shipping industry
 off-shore



Example: PMD100XK with 1/2"NPT connections

Type	max. static pressure	Range
PMD100xx	max. 100 bar	0 - 0.6 upto 0 - 25 bar
PMD160xx	max. 100 bar	0 - 0.6 upto 0 - 25 bar
PMD100xx low	max. 100 bar	0 - 250 upto 0 - 400 mbar
PMD160xx low	max. 25 bar	0 - 25 upto 0 - 400 mbar

Standard connections

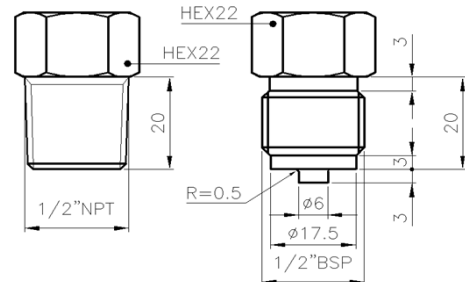

Options : other connections
 connections at 54 mm pitch for case 160 mm
 electrical contacts
 swivel adapters
 manifolds
 chemical seals
 special dials
 connections at 90° angle for case 160 mm

operating principle

- 1 pointer mechanism
- 2 connecting rod
- 3 sensing diaphragm

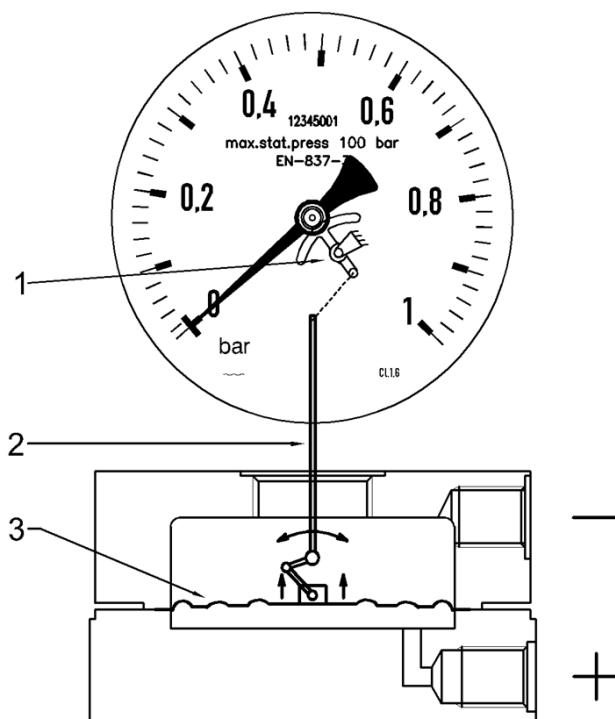

STAINLESS STEEL DIFFERENTIAL PRESSURE GAUGE, TYPE PMD

TYPE PMD, diaphragm system with two measuring chambers

STANDARD MODEL

CASE	: bayonet lock, AISI304/1.4301, IP-65	CONNECTION	: 2x ½"BSP or ½"NPT, AISI316L/1.4404
WETTED PARTS	: AISI316L/1.4404; diaphragm duratherm	MOVEMENT	: AISI304/1.4301
WINDOW	: safety glass	ACCURACY	: ± 1.6% F.S./class 1.6
DIAL	: aluminium, black figures on white	OPTIONS	: see page 57-58, electrical contacts and mechanical transmitters: see page 59-65
POINTER	: aluminium, black		

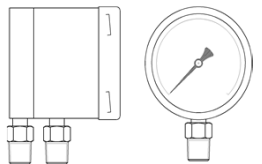
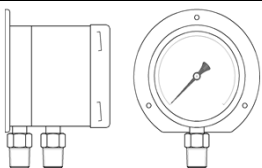
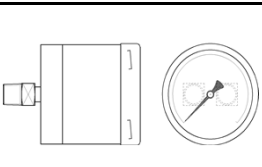
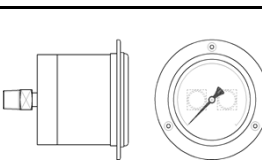
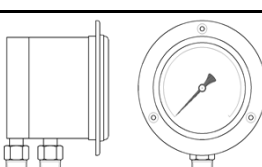
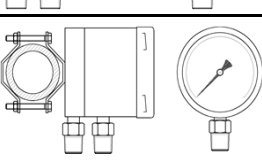
TYPE	MODEL	CASE DIAMETER xxx (Ø in mm)			
		100 250 upto 400 mbar, max. static press. 100 bar	100 0-0,6 upto 25 bar, max. static pressure 100 bar	160 0-25 upto 400 mbar, max. static pressure 25 bar	160 0-0,6 upto 25 bar, max. static pressure 100 bar
K		PMD100XK-low	PMD100XK	PMD160XK-low	PMD160XK
L		PMD100XL-low	PMD100XL	PMD160XL-low	PMD160XL
M		PMD100XM-low	PMD100XM	PMD160XM-low	PMD160XM
N		PMD100XN-low	PMD100XN	PMD160XN-low	PMD160XN
O		PMD100XO-low	PMD100XO	PMD160XO-low	PMD160XO
Y 2" Yoke vert or hor	 pipe Ø44 - Ø70 mm	PMD100XY-low	PMD100XY	PMD160XY-low	PMD160XY
OPTIONS		EXTRA COSTS			
Lx	LIQUID FILLED CASE: GLYCERINE (In combination with electrical device: Ondina oil see page 64)	PMD100Lx-low	PMD100Lx	PMD160Lx-low	PMD160Lx
"Hz" CONTACT DEVICE	EXCLUDING "Hz" CONTACT (see page 59-63)	O.D.		O.D.	

DIFFERENTIAL PRESSURE GAUGE TYPE PMD

TYPE	DRAWING	DIMENSIONS mm																																																											
K PMDxxxXK (-low)		<table border="1" style="width: 100%; border-collapse: collapse;"> <thead> <tr style="background-color: #008080; color: white;"> <th rowspan="2">DIM.</th> <th colspan="5">CASE DIAMETER</th> </tr> <tr style="background-color: #008080; color: white;"> <th>100 low</th> <th>100</th> <th>160 low</th> <th>160</th> <th>+ CONTACT</th> </tr> </thead> <tbody> <tr> <td>A</td> <td>101.5</td> <td>101.5</td> <td>162</td> <td>162</td> <td></td> </tr> <tr> <td>B</td> <td>108</td> <td>108</td> <td>112</td> <td>100</td> <td>+63</td> </tr> <tr> <td>C</td> <td>10.5</td> <td>10.5</td> <td>10.5</td> <td>10.5</td> <td></td> </tr> <tr> <td>E</td> <td>90</td> <td>90</td> <td>119</td> <td>119</td> <td></td> </tr> <tr> <td>T*</td> <td>20</td> <td>20</td> <td>20</td> <td>20</td> <td></td> </tr> </tbody> </table> <p style="font-size: small; text-align: center;">* standard connection 1/2" BSP or 1/2" NPT</p>	DIM.	CASE DIAMETER					100 low	100	160 low	160	+ CONTACT	A	101.5	101.5	162	162		B	108	108	112	100	+63	C	10.5	10.5	10.5	10.5		E	90	90	119	119		T*	20	20	20	20																			
DIM.	CASE DIAMETER																																																												
	100 low	100	160 low	160	+ CONTACT																																																								
A	101.5	101.5	162	162																																																									
B	108	108	112	100	+63																																																								
C	10.5	10.5	10.5	10.5																																																									
E	90	90	119	119																																																									
T*	20	20	20	20																																																									
L PMDxxxXL (-low)		<table border="1" style="width: 100%; border-collapse: collapse;"> <thead> <tr style="background-color: #008080; color: white;"> <th rowspan="2">DIM.</th> <th colspan="5">CASE DIAMETER</th> </tr> <tr style="background-color: #008080; color: white;"> <th>100 low</th> <th>100</th> <th>160 low</th> <th>160</th> <th>+ CONTACT</th> </tr> </thead> <tbody> <tr> <td>A</td> <td>101.5</td> <td>101.5</td> <td>162</td> <td>162</td> <td></td> </tr> <tr> <td>B</td> <td>110</td> <td>110</td> <td>121</td> <td>103</td> <td>+63</td> </tr> <tr> <td>C</td> <td>13.5</td> <td>13.5</td> <td>19.5</td> <td>13.5</td> <td></td> </tr> <tr> <td>D</td> <td>132</td> <td>132</td> <td>196</td> <td>196</td> <td></td> </tr> <tr> <td>E</td> <td>90</td> <td>90</td> <td>119</td> <td>119</td> <td></td> </tr> <tr> <td>P</td> <td>116</td> <td>116</td> <td>178</td> <td>178</td> <td></td> </tr> <tr> <td>H</td> <td>4.8</td> <td>4.8</td> <td>5.8</td> <td>5.8</td> <td></td> </tr> <tr> <td>T*</td> <td>20</td> <td>20</td> <td>20</td> <td>20</td> <td></td> </tr> </tbody> </table> <p style="font-size: small; text-align: center;">* standard connection 1/2" BSP or 1/2" NPT</p>	DIM.	CASE DIAMETER					100 low	100	160 low	160	+ CONTACT	A	101.5	101.5	162	162		B	110	110	121	103	+63	C	13.5	13.5	19.5	13.5		D	132	132	196	196		E	90	90	119	119		P	116	116	178	178		H	4.8	4.8	5.8	5.8		T*	20	20	20	20	
DIM.	CASE DIAMETER																																																												
	100 low	100	160 low	160	+ CONTACT																																																								
A	101.5	101.5	162	162																																																									
B	110	110	121	103	+63																																																								
C	13.5	13.5	19.5	13.5																																																									
D	132	132	196	196																																																									
E	90	90	119	119																																																									
P	116	116	178	178																																																									
H	4.8	4.8	5.8	5.8																																																									
T*	20	20	20	20																																																									
M PMDxxxXM (-low)		<table border="1" style="width: 100%; border-collapse: collapse;"> <thead> <tr style="background-color: #008080; color: white;"> <th rowspan="2">DIM.</th> <th colspan="5">CASE DIAMETER</th> </tr> <tr style="background-color: #008080; color: white;"> <th>100 low</th> <th>100</th> <th>160 low</th> <th>160</th> <th>+ CONTACT</th> </tr> </thead> <tbody> <tr> <td>A</td> <td>101.5</td> <td>101.5</td> <td>162</td> <td>162</td> <td></td> </tr> <tr> <td>B</td> <td>108</td> <td>108</td> <td>112</td> <td>100</td> <td>+63</td> </tr> <tr> <td>E</td> <td>148</td> <td>148</td> <td>152</td> <td>140</td> <td>+63</td> </tr> <tr> <td>T*</td> <td>20</td> <td>20</td> <td>20</td> <td>20</td> <td></td> </tr> </tbody> </table> <p style="font-size: small; text-align: center;">* standard connection 1/2" BSP or 1/2" NPT</p>	DIM.	CASE DIAMETER					100 low	100	160 low	160	+ CONTACT	A	101.5	101.5	162	162		B	108	108	112	100	+63	E	148	148	152	140	+63	T*	20	20	20	20																									
DIM.	CASE DIAMETER																																																												
	100 low	100	160 low	160	+ CONTACT																																																								
A	101.5	101.5	162	162																																																									
B	108	108	112	100	+63																																																								
E	148	148	152	140	+63																																																								
T*	20	20	20	20																																																									

DIFFERENTIAL PRESSURE GAUGE TYPE PMD

TYPE	DRAWING	DIMENSIONS mm																																																																							
N PMDxxxXN (-low)		<table border="1" style="width: 100%; border-collapse: collapse;"> <thead> <tr style="background-color: #008080; color: white;"> <th rowspan="2">DIM.</th> <th colspan="5">CASE DIAMETER</th> </tr> <tr style="background-color: #008080; color: white;"> <th>100 low</th> <th>100</th> <th>160 low</th> <th>160</th> <th>+ CONTACT</th> </tr> </thead> <tbody> <tr><td>A</td><td>101.5</td><td>101.5</td><td>162</td><td>162</td><td></td></tr> <tr><td>B</td><td>108</td><td>108</td><td>112</td><td>100</td><td>+63</td></tr> <tr><td>D</td><td>132</td><td>132</td><td>196</td><td>196</td><td></td></tr> <tr><td>E</td><td>148</td><td>148</td><td>152</td><td>140</td><td>+63</td></tr> <tr><td>F</td><td>3.5</td><td>3.5</td><td>3</td><td>3</td><td></td></tr> <tr><td>G</td><td>13</td><td>13</td><td>15.5</td><td>15.5</td><td></td></tr> <tr><td>H</td><td>4.5</td><td>4.5</td><td>6</td><td>6</td><td></td></tr> <tr><td>P</td><td>116</td><td>116</td><td>178</td><td>178</td><td></td></tr> <tr><td>T*</td><td>20</td><td>20</td><td>20</td><td>20</td><td></td></tr> </tbody> </table> <p style="text-align: center; font-size: small;">* standard connection 1/2"BSP or 1/2"NPT</p>	DIM.	CASE DIAMETER					100 low	100	160 low	160	+ CONTACT	A	101.5	101.5	162	162		B	108	108	112	100	+63	D	132	132	196	196		E	148	148	152	140	+63	F	3.5	3.5	3	3		G	13	13	15.5	15.5		H	4.5	4.5	6	6		P	116	116	178	178		T*	20	20	20	20							
DIM.	CASE DIAMETER																																																																								
	100 low	100	160 low	160	+ CONTACT																																																																				
A	101.5	101.5	162	162																																																																					
B	108	108	112	100	+63																																																																				
D	132	132	196	196																																																																					
E	148	148	152	140	+63																																																																				
F	3.5	3.5	3	3																																																																					
G	13	13	15.5	15.5																																																																					
H	4.5	4.5	6	6																																																																					
P	116	116	178	178																																																																					
T*	20	20	20	20																																																																					
O PMDxxxXO (-low)		<table border="1" style="width: 100%; border-collapse: collapse;"> <thead> <tr style="background-color: #008080; color: white;"> <th rowspan="2">DIM.</th> <th colspan="5">CASE DIAMETER</th> </tr> <tr style="background-color: #008080; color: white;"> <th>100 low</th> <th>100</th> <th>160 low</th> <th>160</th> <th>+ CONTACT</th> </tr> </thead> <tbody> <tr><td>A</td><td>101.5</td><td>101.5</td><td>162</td><td>162</td><td></td></tr> <tr><td>B</td><td>108</td><td>108</td><td>112</td><td>100</td><td>+63</td></tr> <tr><td>C</td><td>10.5</td><td>10.5</td><td>10.5</td><td>10.5</td><td></td></tr> <tr><td>D</td><td>132</td><td>132</td><td>196</td><td>196</td><td></td></tr> <tr><td>E</td><td>90</td><td>90</td><td>119</td><td>119</td><td></td></tr> <tr><td>F</td><td>3.5</td><td>3.5</td><td>3</td><td>3</td><td></td></tr> <tr><td>G</td><td>13</td><td>13</td><td>15.5</td><td>15.5</td><td></td></tr> <tr><td>H</td><td>4.5</td><td>4.5</td><td>6</td><td>6</td><td></td></tr> <tr><td>P</td><td>116</td><td>116</td><td>178</td><td>178</td><td></td></tr> <tr><td>T*</td><td>20</td><td>20</td><td>20</td><td>20</td><td></td></tr> </tbody> </table> <p style="text-align: center; font-size: small;">* standard connection 1/2"BSP or 1/2"NPT</p>	DIM.	CASE DIAMETER					100 low	100	160 low	160	+ CONTACT	A	101.5	101.5	162	162		B	108	108	112	100	+63	C	10.5	10.5	10.5	10.5		D	132	132	196	196		E	90	90	119	119		F	3.5	3.5	3	3		G	13	13	15.5	15.5		H	4.5	4.5	6	6		P	116	116	178	178		T*	20	20	20	20	
DIM.	CASE DIAMETER																																																																								
	100 low	100	160 low	160	+ CONTACT																																																																				
A	101.5	101.5	162	162																																																																					
B	108	108	112	100	+63																																																																				
C	10.5	10.5	10.5	10.5																																																																					
D	132	132	196	196																																																																					
E	90	90	119	119																																																																					
F	3.5	3.5	3	3																																																																					
G	13	13	15.5	15.5																																																																					
H	4.5	4.5	6	6																																																																					
P	116	116	178	178																																																																					
T*	20	20	20	20																																																																					
Y PMDxxxXY (-low) pipe size: 44 - 70 mm	<p style="text-align: center; font-size: x-small;">bracket for horizontal or vertical pipe mounting</p>	<table border="1" style="width: 100%; border-collapse: collapse;"> <thead> <tr style="background-color: #008080; color: white;"> <th rowspan="2">DIM.</th> <th colspan="5">CASE DIAMETER</th> </tr> <tr style="background-color: #008080; color: white;"> <th>100 low</th> <th>100</th> <th>160 low</th> <th>160</th> <th>+ CONTACT</th> </tr> </thead> <tbody> <tr><td>A</td><td>101.5</td><td>101.5</td><td>162</td><td>162</td><td></td></tr> <tr><td>B</td><td>150**</td><td>150**</td><td>154**</td><td>143**</td><td>+63**</td></tr> <tr><td>C</td><td>48**</td><td>48**</td><td>48**</td><td>48**</td><td></td></tr> <tr><td>E</td><td>90</td><td>90</td><td>119</td><td>119</td><td></td></tr> <tr><td>T*</td><td>20</td><td>20</td><td>20</td><td>20</td><td></td></tr> </tbody> </table> <p style="text-align: center; font-size: x-small;">* standard connection 1/2"BSP or 1/2"NPT ** dimensions for 2" pipe size</p>	DIM.	CASE DIAMETER					100 low	100	160 low	160	+ CONTACT	A	101.5	101.5	162	162		B	150**	150**	154**	143**	+63**	C	48**	48**	48**	48**		E	90	90	119	119		T*	20	20	20	20																															
DIM.	CASE DIAMETER																																																																								
	100 low	100	160 low	160	+ CONTACT																																																																				
A	101.5	101.5	162	162																																																																					
B	150**	150**	154**	143**	+63**																																																																				
C	48**	48**	48**	48**																																																																					
E	90	90	119	119																																																																					
T*	20	20	20	20																																																																					

STANDARD PRESSURE RANGES FOR TYPES:

**PBX, PBX-TG, PBX-SF, PBB, PMX, PPB, PBS, PFS, PBQ, PFQ, PBR, PBT, RPX, RPP, PBX-SS,
DIFFERENTIAL PRESSURE GAUGES**

PRESSURE RANGES				EXTRA COSTS																		
(in bar)*****	SCALE DIVISION			CASE DIMENSIONS (in mm)																		
	cl. 1.0 cl. 1.6	OPTION		Ø 63	Ø 80	Ø 100	Ø 160	Ø 250	72x72	96x96	144x144	192x192 280x280 380x380 400x300 500x400	72x144 144x72	192x96 96x192								
		cl. 0.6 cl. 0.5	only PBX-TG cl. 0.3 cl. 0.25																			
-1 ...0	0.02	0.005	0.005																			
-1 ...0.6	0.05	0.01	0.005																			
-1 ...1.5	0.05	0.02	0.01																			
-1 ...3	0.1	0.02	0.01																			
-1 ...5	0.1	0.05	0.02																			
-1 ...9	0.2	0.05	0.05																			
-1 ...15	0.5	0.1	0.05																			
-1 ...24	0.5	0.2	0.1																			
0 ...0.6	0.01	x	x																			
0 ...1	0.02	0.005	0.005																			
0 ...1.6	0.05	0.01	0.005																			
0 ...2.5	0.05	0.02	0.01																			
0 ...4	0.1	0.02	0.01																			
0 ...6	0.1	0.05	0.02																			
0 ...10	0.2	0.05	0.05																			
0 ...16	0.5	0.1	0.05																			
0 ...25	0.5	0.2	0.1																			
0 ...40	1	0.2	0.1																			
0 ...60	1	0.5	0.2																			
0 ...100	2	0.5	0.5																			
0 ...160	5	1	0.5																			
0 ...250 CE	5	2	1																			
0 ...400 CE	10	2	1																			
0 ...600 CE	10	5	2																			
0 ...1000 CE	20	5	5																			
0 ...1600 CE	50	x	x	x	x			x					x	x								
0 ...2000 CE	50	x	x	x	x			x	x	x	x	x	x	x								
0 ...2500* CE	50	x	x	x	x			x	x	x	x	x	x	x								
0 ...3000* CE	50	x	x	x	x			x	x	x	x	x	x	x								
0 ...4000** CE	50	x	x	x	x		See p14	x	x	x	x	x	x	x								
0 ...5000***, 0 ... 6000*** and 0 ...7000*** - see page 14 CE																						
NON STANDARD RANGES																						
e.g. 0-7 bar or 0-110 psi																						
DOUBLE SCALES																						
e.g. bar/psi, bar/kPa, etc.																						
FREON SCALES e.g. R12, R134A, R22, R404A, R407C, R502, R504, R717, NH3																						
ACCURACY																						
±1.6% F.S. (class 1.6)				•	•	x	x	x	•	•	x	x	x	x								
±1.0% F.S. (class 1.0)						•	•	•			•	•	•	•								
±0.6 / 0.5 %F.S. (class 0.6 or 0.5)***				x	x				x	x												
±0.3 / 0.25 %F.S. (class 0.3 or 0.25) ****				x	x	x	****	****	x	x	x	x	x	x								
Mirrorscale (standard for PBX-TG, page 12)				x	x	x			x	x	x	x	x	x								
TRM scales																						
0 ...100 % lin.																						
0 ...10 square root																						
0.2 ...1 bar																						
3 ...15 psi																						
20 ...100 kPa																						
<table style="width: 100%; border: none;"> <tr> <td style="width: 20px; border: 1px solid black; text-align: center;">x</td> <td style="border: none;">NOT AVAILABLE</td> <td style="border: none;">* ELEMENT CrMo52 i.o. AISI316Ti/1.4571</td> <td style="border: none;">*** ONLY FOR TYPE PBX OR PBX-SF</td> </tr> <tr> <td style="width: 20px; border: 1px solid black; text-align: center;">•</td> <td style="border: none;">STANDARD</td> <td style="border: none;">** ELEMENT NiSpan C i.o. AISI316Ti/1.4571</td> <td style="border: none;">****ONLY FOR TYPE PBX-TG - see page 12</td> </tr> </table>															x	NOT AVAILABLE	* ELEMENT CrMo52 i.o. AISI316Ti/1.4571	*** ONLY FOR TYPE PBX OR PBX-SF	•	STANDARD	** ELEMENT NiSpan C i.o. AISI316Ti/1.4571	****ONLY FOR TYPE PBX-TG - see page 12
x	NOT AVAILABLE	* ELEMENT CrMo52 i.o. AISI316Ti/1.4571	*** ONLY FOR TYPE PBX OR PBX-SF																			
•	STANDARD	** ELEMENT NiSpan C i.o. AISI316Ti/1.4571	****ONLY FOR TYPE PBX-TG - see page 12																			

***** Scale in Psi, kPa, kg/cm², mWC etc. available with no extra charge

STANDARD PRESSURE RANGES FOR TYPES: PCX, PMX, PPC, PCD, PMD

PRESSURE RANGES												
(in mbar) **		SCALE DIVISION		CASE DIMENSIONS (in mm)								
		cl. 1.6	option cl. 1.0	Ø 100	Ø 160	Ø 250	72x72	96x96	144x144	192x192	72x144 144x72	192x96 96x192
-4 ...0*	0 ...4*	0.1	0.1	x	•	x	x	x	•	•	x	•
-6 ...0*	0 ...6*	0.1	0.1	x	•	x	x	x	•	•	x	•
-10 ...0*	0 ...10*	0.2	0.2	x	•	x	x	x	•	•	•	•
-16 ...0*	0 ...16*	0.5	0.5	x	•	x	x	x	•	•	•	•
-25 ...0	0 ...25	0.5	0.5	•	•	•	x	•	•	•	•	•
-40 ...0	0 ...40	1	1	•	•	•	•	•	•	•	•	•
-60 ...0	0 ...60	1	1	•	•	•	•	•	•	•	•	•
-100 ...0	0 ...100	2	2	•	•	•	•	•	•	•	•	•
-160 ...0	0 ...160	5	5	•	•	•	•	•	•	•	•	•
-250 ...0	0 ...250	5	5	•	•	•	•	•	•	•	•	•
-400 ...0	0 ...400	10	10	•	•	•	•	•	•	•	•	•
-2.5 ...1.5*	-1.5 ...2.5*	0.1	0.1	x	•	x	x	x	•	•	x	•
-4 ...2*	-2 ...4*	0.1	0.1	x	•	x	x	x	•	•	x	•
-6 ...4*	-4 ...6*	0.2	0.2	x	•	x	x	x	•	•	•	•
-10 ...6*	-6 ...10*	0.5	0.5	x	•	x	x	x	•	•	•	•
-15 ...10	-10 ...15	0.5	0.5	•	•	•	x	•	•	•	•	•
-25 ...15	-15 ...25	1	1	•	•	•	•	•	•	•	•	•
-40 ...20	-20 ...40	1	1	•	•	•	•	•	•	•	•	•
-60 ...40	-40 ...60	2	2	•	•	•	•	•	•	•	•	•
-100 ...60	-60 ...100	5	5	•	•	•	•	•	•	•	•	•
-150 ...100	-100 ...150	5	5	•	•	•	•	•	•	•	•	•
-250 ...150	-150 ...250	10	10	•	•	•	•	•	•	•	•	•
NON STANDARD RANGES:												
e.g. 0-50 mbar etc.												
DOUBLE SCALES												
e.g. mbar/mmWC, mbar/Pa, etc.												
ACCURACY												
±1.6% F.S. / class 1.6				•	•	•	•	•	•	•	•	•
±1.0% F.S. / class 1.0 *							x				x	x
Mirrorscale				x			x	x	x	x	x	x

NOT AVAILABLE STANDARD

* not for type PMX and ALL differential pressure gauges

** Scale in psi, kPa, kg/cm², mWC etc. available with no extra charge

MARKING FOR PRESSURE GAUGES

OPTIONS	EXTRA PRICE
TAG number on dial	
TAG number on AISI304/1.4301 TAG plate 55x25 mm	
Lettering on dial	
Red mark on dial	

CERTIFICATES FOR PRESSURE GAUGES

TYPE OF CERTIFICATE	NET PRICES
Certificate of Conformity acc. to EN 10204 2.2.	
Material certificate wetted parts acc. to EN 10204 3.1	
ATEX certification, including ATEX on the dial; only possible with STIKO logo for gauges without contact INSTRUMENTS WITH ATEX CERTIFICATION SHALL ALSO HAVE SAFETY GLASS AND A BLOW - OUT	PER ORDER
ATEX certification, including ATEX on the dial; only possible with STIKO logo for gauges with inductive contact INSTRUMENTS WITH ATEX CERTIFICATION SHALL ALSO HAVE SAFETY GLASS AND A BLOW - OUT	PER INSTRUMENT
Pressure (Bar)	<=2500 2500-4000 >=4000
Calibration certificate pressure gauge (standard for PBX-TG - see page 12)	Certificate traceable to international standards
Calibration certificate pressure gauge with transmitter (see page 64)	
Calibration certificates for type PBB (duplex)	

OPTIONS ON PRESSURE GAUGES

TYPE	CASE DIMENSIONS (in mm)	EXTRA COSTS							
		CONNECTIONS						CASE & BEZEL	
		1/8" BSP/NPT max. 400 bar	1/4" BSP/NPT max. 1000 bar	1/2" BSP max. 2500 bar***, 1/2" NPT max. 1000 bar	3/8" BSP/NPT max. 1000 bar	M20x1.5 max. 1600 bar	M16x1.5 H.P. female max. 7000 bar**	9/16" UNF x 18 H.P. female max. 7000 bar**	AISI316L / 1.4404
PBX	063		•						×
	080		•					×	×
	100			•					
	160			•				*	*
	250			•				×	×
PBX-SF	063		•					○	×
	100			•				○	
	160			•				○	
PBB	100			•				×	×
	160			•				×	×
PCX	100			•			×	×	
	160			•			×	×	
	250			•			×	×	×
PMX	100			•			×	×	×
	160			•			×	×	×
PPB - PPC	square		•				×	×	×
	rectangular		•				×	×	×
PBS - PBQ	063	ON DEMAND: SEE ALSO PAGE 23-41							
PFS - PFQ	080							×	×
	100								
	160								
PBR - PBT	100	SEE PAGE 42-43							×
	160								×
PCD	100			•			×	×	
	160			•			×	×	
PBD	100			•			×	×	×
	160			•			×	×	×
PMD	100			•			×	×	
	160			•			×	×	×
POD	100						×	×	×
	160						×	×	*
RPX	ALL			•				×	×
PBX-SS	063		•					•	•
	100			•				•	•
	160			•				•	•

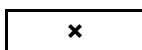

NOT AVAILABLE

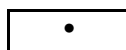

STANDARD

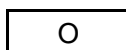

ON DEMAND

* Not possible in combinations with contacts or transmitters

** Not available with pulsation damper

*** As per DIN16001

OPTIONS ON PRESSURE GAUGES

TYPE	CASE DIMENSIONS (in mm)	EXTRA COSTS													
		WINDOW MATERIAL			BLOW- OUT		POINTERS					MEASURING SYSTEM			
		PMMA - PLEXIGLASS	SECURIT	LAMINATED SAFETY GLASS	DISC	PLUG * (LIQUID FILLED)	ADJUSTABLE	INDEX POINTER ON GLASS	DRAG POINTER		DRAG POINTER in combination with HZ contact	OIL & GREASE FREE**	MONEL WETTED PARTS	PULSATION DAMPER AISI316 1.4401	OVERLOAD 2x F.S. other on demand
									Single	Double					
PBX	063				●	●					×	×			
	080				●	●					×	×			
	100				●	●									
	160				●	●									
	250				●	●					×		×		
PBX-SF	063	×	×	●	×	×					×	×			
	100	×	×	●	×	×					×				
	160	×	×	●	×	×					×				
PBB	100				●	●	×				×				
	160				●	●	×				×				
PCX	100				●	●				○	×	×	×	×	see page 16
	160				●	●				○	×	×	×	×	
	250				●	●				×	×	×	×	×	
PMX	100				●	●					×		×	×	see page 17-18
	160				●	●					×		×	×	
PPB	square	●	×	×	×	×					×		×		○
PPC	rectangular	●	×	×	×	×	×	×	×	×	×		×		○
PBS	063		×		●	●					×	×	○		○
PBQ	080		×	×	●	●					×	×	○		○
PFS	100				●	●					×		○		○
PFQ	160				●	●					×		○		○
PBR	100				●	●					×		○		○
PBT	160				●	●					×		○		○
PCD	100	×		×	×	×		×	×	×	×	×	×		see page 46
	160	×		×	×	×		×	×	×	×	×	×		
PBD	100				●	●					×		×		×
	160				●	●					×		×		×
PDD	100				●	●					×	×	×		×
PMD	160				●	●					×	×	×		×
POD	100				●	●					×	×	×	×	×
	160				●	●					×	×	×	×	×
RPX	ALL	●	see page 21,	×	×	×	●	×	×	×	×		×	×	
RPP		●	22	×	×	×	●	×	×	×	×		×	×	
PBX-SS	063	×	●	×	×	×		×	×	×	×				
	100	×	●	×	×	×		×	×	×	×				
	160	×	●	×	×	×		×	×	×	×				

× NOT AVAILABLE
 ● STANDARD
 ○ ON DEMAND
 * WITH COMPENSATING DIAPHRAGM
 ** Only PBX-SFxxxXX is suitable for use on oxygen!!